

Cam & Groove Fittings



Dixon, Boss-Lock, EZ Boss-Lock, swaged-on and phonograph finish, polypropylene, reducing couplers, adapters, gaskets, replacement handles, accessories, Strap-Grip

A p.16

Dry Disconnects Fittings



Dry disconnect fittings, dry gas, dry aviation, dry break, Flomax connectors, safety break away fittings

B p.67

Swivel Joints



Single, double and triple plane V-ring type and O-ring type swivels

C p.85

Boss Fittings

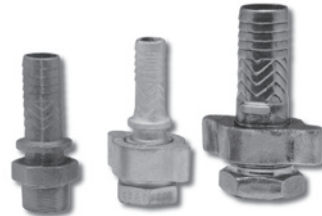

Boss and EZ-Boss ground joint and washer type couplings, male and LP stems, Boss clamps, air hammer fittings, Boss Holedall fittings, steam quick disconnects, hammer unions, Dixon mining fittings

D p.90

Air Fittings

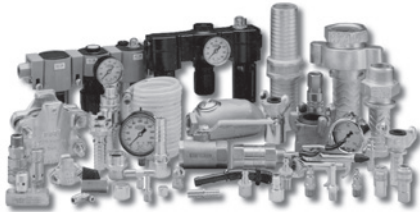

Manifolds, Air King universal couplings, King cable, Dix-Lock, Dual-Lock, Air Chief quick connects, air valves, blow guns, tube fittings and valves, FRL's, thermometers, gauges, hose racks and reels, safety check valves

E p.101

Shank Fittings



Menders, nipples, suction couplings, foot valves, strainers, skimmers, long and short shank fittings, spray hose couplings, quick connects, inserts

F p.263

Brass Fittings



Hose stations, nozzles, garden hose fittings, garden hose, shank fittings, ferrules, crimping tools, pressure gun and accessories, grease whip assemblies, push-on fittings, short shank fittings

G p.285

Plastic Fittings



Quick disconnect fittings, PVC tubing, tubing cutters, Tuff-Lite nylon and polypropylene hose fittings, acetal fittings, push-in fittings

H p.319

Clamps



Pinch-on, worm gear, band clamps, Strap-Grip, single and double bolt clamps, spiral clamps, T-bolt clamps, clamp kits, tools and accessories, spring hose clamps, thumb screw clamps, constant torque clamps

I p.331

Hydraulic Fittings



Straight through's, Flo-Mate, flow control valves, high pressure ball valves, needle valves, hydraulic quick connects, return line fittings, plugs and caps, swivel adapters, hydraulic couplings, flat face fittings

J p.346

Holedall Fittings

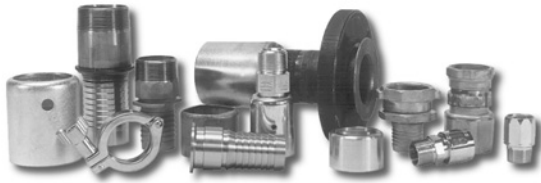

Rams, Holedall externally swaged fittings, flanged assemblies, notched fittings, Holedall internally expanded fittings, sanitary fittings, Holedall petroleum fittings, petroleum coupling expanders, API certified fittings

K p.375

Sanitary Fittings



Clamp fittings, 3A gaskets, weld fittings, bevel seat fittings, John Perry, Q-Line, and I-line fittings, butt weld fittings, tube O.D. fittings and hangers, ball valves, butterfly valves, check valves

L p.392

Fire Hose Fittings



Flat Seal couplings, fire hose, reels, clappers, expansion ring couplings, wrenches, adapters, swivels, nipples, valves, thermoplastic, brass and aluminum nozzles, dry hydrants, Storz fittings, expanders

M p.441

Valves

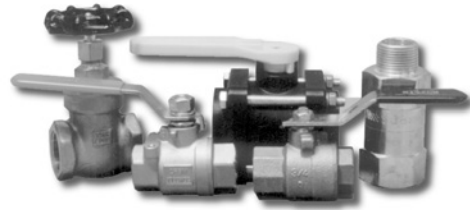

Ball valves, locking ball valves, steam valves, mini valves, pneumatically actuated valves, non-metallic ball valves, strainers, gate valves, butterfly valves, air valves, globe valves, faucets

N p.494

Pipe & Welding Fittings



Weld end fittings, welding nipples, flanges, turned back fittings, NPT threaded fittings, nipples, sight flow indicators, grooved pipe fittings, Straub couplings

O p.526

Tank Truck Fittings



Tight and loose fill couplers and adapters, shank couplings, pipe caps, sight flow indicators, reducers and adapters for tank trucks, Bayco hose swivels, Bayco hose nozzles, rack cords, dry disconnects, nozzles

P p.557

Rack Equipment



Swivels, safety break-away couplings, TTMA flange adapters, API coupler, API rack cords, flanged sight flow indicators, TTMA flange extensions, Type 35 loading arm swivel

Q p.575

Maintenance & Repair



Thread tape, test pumps, coupling inserter, hose mallet, hose knife, hose jackets and guards, hose tags, ties and tape, fiberglass sleeves

R p.585

PTFE Hose & Fittings



Nominal fittings, true ID fittings, smooth bore PTFE conductive and non-conductive hose, open pitch convoluted hose, heavy wall true ID smooth bore hose

S p.593

This catalog is intended as a product offering. It is not intended to be a user or technical manual. Information in this catalog is subject to change without notice. All users and distributors of products sold through this catalog should contact Dixon with questions of use, compatibilities, coupling procedures and life of product. Dixon's full-time engineering and test staff is always available to recommend uses and to assist distributors and users with any questions. For safety related information, please refer to pages 2 - 7.

This safety alert logo, which appears throughout our catalog, is used as a reminder that the user should carefully review for safety the appropriateness of the product for the media, application and environment in which it will be used.

**SAFETY
ALERT**

A
Cam &
Groove

B
Dry
Disconnect

C
Swivels

D
Boss

E
Air

F
Shank

G
Brass

H
Plastic

I
Clamps

J
Hydraulic

K
Holedall

L
Sanitary

M
Fire

N
Valves

O
Pipe &
Welding

P
Tank
Truck

Q
Rack
Equipment

R
Maint. &
Repair

S
PTFE
Hose

T
Technical

Hose Assembly Safety Program

HUIYA, in partnership with your industrial hose supplier, is pleased to offer a hose and coupling safety survey of your plant, at no cost to you, to assist in your efforts to make your facility as safe, efficient and productive as possible.

Today, plant safety is an enormous, ongoing endeavor in which it is impossible to be an expert in every field.

The use of damaged or misapplied hose couplings and related items occurs. To the untrained eye, these hazards may continue to exist until an accident happens, threatening not only plant machinery, but also the well-being of plant personnel.

Our program includes a visual inspection of hose assemblies and related accessories in your plant by trained technicians. A professionally written report containing our observations and recommendations for corrective action is subsequently provided to augment your own ongoing safety program. If desired, photographs of the areas of concern can be supplied with the report. As a follow-up, the program offers an educational hands-on seminar directly relating to the safety concerns in your facility.

Plant safety is coming under increasing scrutiny by various regulatory agencies. Let HUIYA's trained personnel assist you in establishing and maintaining safety compliance in your plant.

The safety survey report is completely confidential and will only be shown to authorized plant personnel. Again, there is no cost to you for this service.

Safety Products and Recommendations in the Dixon Price List

Safety is everyone's concern!

HUIYA provides many safety products designed to protect personnel and property. Recommendations and safety warnings are also included for your review.

Hose and coupling safety	pages 2-3
S.T.A.M.P.E.D.	page 4
Pressure recommendations	pages 8-13
EZ Boss-Lock handles	page
Cam and groove safety clips	page
Air King - not to be used for steam statement	pages
King cable safety cables.....	page
Safety shut-off valves, OSHA REG. 1926.302	page
30 PSI safety blow guns.....	page
Safety vented ball valves.....	page
Safety tags and safety tape.....	page
The importance of whip hose statement	pages 6,

Pressure Recommendations

The images shown on these two pages are provided to assist in coupling and clamp or ferrule identification for the pressure recommendation chart on pages 10 - 13.

Couplings



Dixon Cam & Groove



Machined Short Shank



Holedall Internal Expansion



Boss Couplings

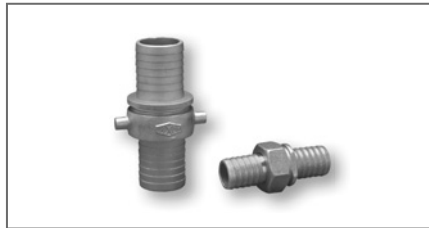

Cast Short Shank



Flow Chief / Sanitary



Air King Universal



Push-On

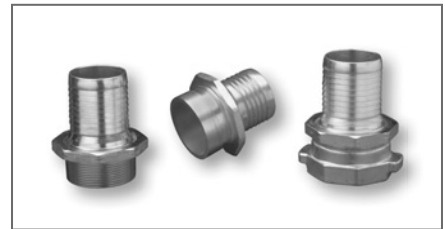

Holedall Internal Expansion Petroleum



King Machined Medium Shank



Reusable Brass



Flat Seal



King Machined Long Shank



Holedall Swage / Crimp

Pressure Recommendations

1. The chart on pages 10 - 13 is intended as a guide only. It only applies to metal couplings as shown for ambient temperature (70°F) applications with true I.D. hose. It assumes new Dixon supplied couplings, new Dixon supplied clamps, new quality hose and proper installation by a qualified assembler using Dixon procedures and equipment. Temperature can affect the coupling retention. For questions relating to temperatures other than ambient (70°F) contact the hose manufacturer or Dixon at 1-800-355-1991.
2. This chart does not apply to non-Dixon products, with used hose, in non-approved or unsupported applications or in non-standard assemblies.
3. Do not use this chart if it conflicts with the hose manufacturer's recommendations.
4. All hose assemblies should be pressure tested to hose manufacturers or Rubber Manufacturers Association (R.M.A.) specifications prior to being put into service.
5. Our test experience indicates that coupling retention can vary with changes in hose design. For pressure ratings other than those listed and shown, or if questions arise, please call Dixon Valve & Coupling Company at 1-800-355-1991 for assistance.
6. All hose assembly components must be compatible with the materials and environments with which they are to come in contact.
7. Dixon recommends that all hose assemblies be marked with the assembly working pressure and media of the intended application. Under no circumstances should the assembly working pressure exceed the working pressure of the lowest rated component (coupling, clamp, ferrule or hose).
8. For further safety information refer to pages 2-7.

Clamps and Ferrules



Boss Interlocking Clamps

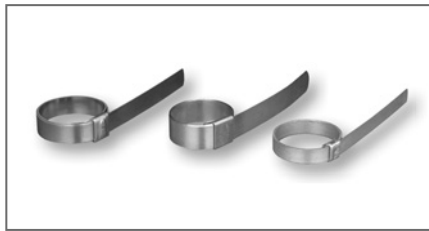

Prefomed Clamps

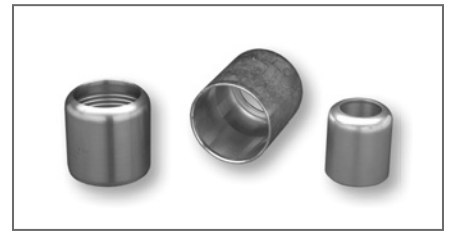

Internal Expansion



Air King Interlocking Clamps



Double Bolt Clamps



Internal Expansion Petroleum

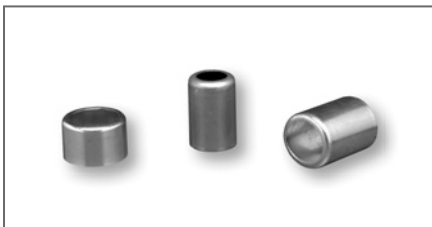

Crimp



Swage / Crimp



Flat Seal



Band & Buckle

Pressure Recommendations

Mark hose assembly with pressure from this chart or hose working pressure, whichever is **lower**.

All pressure recommendations are in pounds per square inch (PSI).

- This chart is intended as a guide only. It only applies to metal couplings as shown for ambient temperature (70°F) applications with true I.D. hose. It assumes new Dixon supplied couplings, new Dixon supplied clamps, new quality hose and proper installation by a qualified assembler using Dixon procedures and equipment.
Temperature can affect the coupling retention. For questions relating to temperatures other than ambient (70°F) contact the hose manufacturer or Dixon at 1-800-355-1991.
- This chart does not apply to non-Dixon products, with used hose, in non-approved or unsupported applications or in non-standard assemblies.

Hose (rubber covered)	Couplings	DPL sect.	Clamps & Ferrules	* Assembly * Procedure	1/4"	3/8"	1/2"	5/8"	3/4"
Air <i>textile reinforced rubber lined</i>	Air King Universal	E	Preformed Band Clamp	2102			150	150	150
	Machined - Short Shank	F	Crimp	2304	200	150	150	100	100
	Machined - Short Shank	F	Preformed Band Clamp	2100-2101			150	100	100
	Reusable - Brass	G	n/a	2305	250	250	250		
	King Machined - Medium Shank	F	Preformed Band Clamp	2100-2101			250	200	200
	King Machined - Long Shank	F	Preformed Band Clamp	2100-2101			300	300	300
Air <i>textile or wire reinforced rubber lined</i>	Air King Universal	E	Air King or Boss Interlocking Clamp	2000		150	150		150
	Air King Universal	E	Swage/Crimp	see DPL			150		150
	Boss Couplings	D	Boss Interlocking Clamp	2000-2004	600	600	600		600
	Holedall Swage/Crimp	K	Swage/Crimp	see Ram Manual	600	600	600		600
Asphalt & Hot Tar	Boss Couplings	D	Boss Interlocking Clamp	2001-2002					
Chemical <i>plastic lined for liquid service</i>	King Machined - Medium Shank	F	Preformed Band Clamp	2100-2101			125		125
	King Machined - Medium Shank	F	Band & Buckle	2104					
	King Machined - Long Shank	F	Preformed Band Clamp	2100-2101			150		150
	King Machined - Long Shank	F	Band & Buckle	2104					
	Boss-Lock Cam & Groove	A	Preformed Band Clamp	2100-2101			150		150
	Boss-Lock Cam & Groove	A	Band & Buckle	2104					
	Boss-Lock Cam & Groove	A	Swage/Crimp	see Ram Manual					250
	Holedall Swage/Crimp	K	Swage/Crimp	see Ram Manual			600		600
Chemical <i>rubber lined for liquid service</i>	King Machined - Medium Shank	F	Preformed Band Clamp	2100-2101			125		125
	King Machined - Medium Shank	F	Band & Buckle	2104					
	King Machined - Long Shank	F	Preformed Band Clamp	2100-2101			150		150
	King Machined - Long Shank	F	Band & Buckle	2104					
	Boss-Lock Cam & Groove	A	Preformed Band Clamp	2100-2101			150		150
	Boss-Lock Cam & Groove	A	Band & Buckle	2104					
	Boss-Lock Cam & Groove	A	Swage/Crimp	see Ram Manual					250
	Boss Couplings	D	Boss Interlocking Clamp	2000-2004			600		600
	Holedall Internal Expansion	K	Internal Expansion	see Ram Manual					
	Holedall Swage/Crimp	K	Swage/Crimp	see Ram Manual			600		600
Food Grade <i>conforming to 3A</i>	Flow Chief Sanitary	K	Internal Expansion	see Ram Manual					
Food Grade <i>rubber lined</i>	King Machined - Medium Shank	F	Preformed Band Clamp	2100-2101			125		125
	King Machined - Medium Shank	F	Band & Buckle	2104					
	Boss-Lock Cam & Groove	A	Preformed Band Clamp	2100-2101			150		150
	Boss-Lock Cam & Groove	A	Band & Buckle	2104					
	Boss-Lock Cam & Groove	A	Swage/Crimp	see Ram Manual					250
	Holedall Internal Expansion	K	Internal Expansion	see Ram Manual					
	Holedall Swage/Crimp	K	Swage/Crimp	see Ram Manual			600		600
Layflat	Flat Seal	A / M	Flat Seal Clamps	2202					

Pressure Recommendations

3. Do not use this chart if it conflicts with the hose manufacturer's recommendations.
4. All hose assemblies should be pressure tested to hose manufacturers or Rubber Manufacturers Association (R.M.A.) specifications prior to being put into service.
5. Our test experience indicates that coupling retention can vary with changes in hose design. For pressure ratings other than those listed and shown.
6. All hose assembly components must be compatible with the materials and environments with which they are to come in contact.
7. Dixon recommends that all hose assemblies be marked with the assembly working pressure and media of the intended application. Under no circumstances should the assembly working pressure exceed the working pressure of the lowest rated component (coupling, clamp, ferrule or hose).
8. For further safety information refer to pages 2-7.

Hose (rubber covered)	1"	1-1/4"	1-1/2"	2"	2-1/2"	3"	4"	5"	6"	Notes
Air textile reinforced rubber lined	150									(2) bands on 5/8" or larger; Must use mating Dixon Air King fittings with safety clip installed.
	100									
	100									
										(2) bands on 1/2" to 1"
	150									
	300									
Air textile or wire reinforced rubber lined	150									Must use mating Dixon Air King fittings with safety clip installed.
	150									Coupling and ferrule are sold assembled. Must use mating Dixon Air King fittings with safety clip installed.
	600	600	600	600	450	450	250		250	
	600	600	600	600	600	600	500	450	400	
Asphalt & Hot Tar	200	200	200	200	200	200	200			Consult factory
Chemical plastic lined for liquid service	125	125	125	75	75	50	50			(3) bands on 3" & 4"; (2) bands on 1-1/2" to 2-1/2"; (1) band on the rest
		125	125	75	75	50	50			(3) bands on 3" & 4"; (2) bands on 1-1/2" to 2-1/2"; (1) band on the rest
	150	150	150	125	100	75	75			(5) bands on 3" & 4"; (4) bands on 2" & 2-1/2"; (3) bands on 1-1/4" & 1-1/2"; (2) bands on the rest
		150	150	125	100	75	75			(5) bands on 3" & 4"; (4) bands on 2" & 2-1/2"; (3) bands on the rest
	250	250	250	250	150	125	100			
		250	250	250	150	125	100			
	250		250	250		125	100			Requires properly matched stem and ferrule.
	600	600	600	600	600	600	500			
Chemical rubber lined for liquid service	125	125	125	75	75	50	50			(3) bands on 3" & 4"; (2) bands on 1-1/2" to 2-1/2"; (1) band on the rest
		125	125	75	75	50	50			(3) bands on 3" & 4"; (2) bands on 1-1/2" to 2-1/2"; (1) band on the rest
	150	150	150	125	100	75	75			(5) bands on 3" & 4"; (4) bands on 2" & 2-1/2"; (3) bands on 1-1/4" & 1-1/2"; (2) bands on the rest
		150	150	125	100	75	75			(5) bands on 3" & 4"; (4) bands on 2" & 2-1/2"; (3) bands on the rest
	250	250	250	250	150	125	100			
		250	250	250	150	125	100			
	250		250	250		125	100			Requires properly matched stem and ferrule.
	600	600	600	600	450	450	250			
	800	800	800	800	600	600	500			Consult factory for ratings on IXF48-3 to IXF48-5 & IXF64-2 to IXF64-5 ferrules. Internal Expansion is NOT recommended for XLPE, UHMWPE & Gum Rubber lined hoses.
600	600	600	600	600	600	500				
Food Grade conforming to 3A			250	250		250				Use Stainless Steel Food Grade Ferrule ONLY.
Food Grade rubber lined	125	125	125	75	75	50	50	25	25	(4) bands on 6"; (3) bands on 3" to 5"; (2) bands on 1-1/2" to 2-1/2"; (1) band on the rest
		125	125	75	75	50	50	25	25	(4) bands on 6"; (3) bands on 3" to 5"; (2) bands on 1-1/2" to 2-1/2"; (1) band on the rest
	250	250	250	250	150	125	100	75	75	(3) bands on 6"; (2) bands on the rest
		250	250	205	150	125	100	75	75	(3) bands on 6"; (2) bands on the rest
	250		250	250		125	100			Requires properly matched stem and ferrule.
	250		250	250	250	250	200			
	600	600	600	600	600	600	500	450	400	
Layflat			300	300	300	300	225		150	To be used as a set ONLY. <u>6" Cam & Groove couplings are rated to 75PSI.</u>

Pressure Recommendations

Hose (rubber covered)	Couplings	DPL sect.	Clamps & Ferrules	* Assembly * Procedure	1/4"	3/8"	1/2"	5/8"	3/4"
Material Handling <i>rubber lined</i>	Cast Short Shank	F	Preformed Band Clamp	2100-2101					
	Cast Short Shank	F	Band & Buckle	2104					
	King Machined - Medium Shank	F	Preformed Band Clamp	2100-2101					
	King Machined - Medium Shank	F	Band & Buckle	2104					
	King Machined - Long Shank	F	Preformed Band Clamp	2100-2101					
	King Machined - Long Shank	F	Band & Buckle	2104					
	Boss-Lock Cam & Groove	A	Preformed Band Clamp	2100-2101					
	Boss-Lock Cam & Groove	A	Band & Buckle	2104					
	Boss-Lock Cam & Groove	A	Swage/Crimp	see Ram Manual					
	Holedall Swage/Crimp	K	Swage/Crimp	see Ram Manual					
	Holedall Internal Expansion	K	Internal Expansion	see Ram Manual					
Material Handling <i>no helical wire rubber lined</i>	Cast Short Shank	F	Double Bolt Clamp	2201					
	King Machined - Medium Shank	F	Double Bolt Clamp	2201					
	King Machined - Long Shank	F	Double Bolt Clamp	2201					
Material Handling <i>cement rubber lined</i>	Boss Couplings	D	Boss Interlocking Clamp	2000-2004					
	Holedall Swage/Crimp	K	Swage/Crimp	see Ram Manual					
	Holedall Internal Expansion	K	Internal Expansion	see Ram Manual					
Petroleum Transfer	King Machined - Medium Shank	F	Preformed Band Clamp	2100-2101			125		125
	King Machined - Medium Shank	F	Band & Buckle	2104					
	King Machined - Long Shank	F	Preformed Band Clamp	2100-2101			150		150
	King Machined - Long Shank	F	Band & Buckle	2104					
	Boss-Lock Cam & Groove	A	Preformed Band Clamp	2100-2101			150		250
	Boss-Lock Cam & Groove	A	Band & Buckle	2104					
	Boss-Lock Cam & Groove	A	Swage/Crimp	see Ram Manual					250
	Holedall Internal Expansion	K	Internal Expansion	see Ram Manual					
	Holedall Swage/Crimp	K	Swage/Crimp	see Ram Manual			600		600
Air Craft Refueling <i>conforming to API 1529</i>	Holedall Internal Expansion (Petroleum)	K	Internal Expansion (Petroleum)	see Ram Manual					
Push-On	Push-On	G	n/a	2001-2002	175	175	175	175	175
Steam	Boss Couplings	D	Boss Interlocking Clamp	2000-2004			250		250
Water	Air King Universal	E	Preformed Band Clamp	2100-2101			150	150	150
	Air King Universal	E	Air King or Boss Interlocking Clamp	2000-2001		150	150		150
	Machined - Short Shank	F	Preformed Band Clamp	2100-2101			150	100	100
	Machined - Short Shank	F	Crimp	2304	200	150	150	100	100
	Cast Short Shank	F	Preformed Band Clamp	2100-2101			150	100	100
	Cast Short Shank	F	Band & Buckle	2104					
	King Machined - Medium Shank	F	Preformed Band Clamp	2100-2101			250	200	200
	King Machined - Long Shank	F	Preformed Band Clamp	2100-2101			300	300	300
	Boss-Lock Cam & Groove	A	Preformed Band Clamp	2100-2101			150		250
	Boss-Lock Cam & Groove	A	Band & Buckle	2104					
	Boss-Lock Cam & Groove	A	Swage/Crimp	see Ram Manual					250
	Boss Couplings	D	Boss Interlocking Clamp	2000-2002	600	600	600		600
	Holedall Swage/Crimp	K	Swage/Crimp	see Ram Manual	600	600	600		600
Water <i>no helical wire</i>	Cast Short Shank	F	Double Bolt Clamp	2201					
	King Machined - Medium Shank	F	Double Bolt Clamp	2201					
	King Machined - Long Shank	F	Double Bolt Clamp	2201					

Pressure Recommendations

Hose (rubber covered)	1"	1-1/4"	1-1/2"	2"	2-1/2"	3"	4"	5"	6"	Notes
Material Handling <i>rubber lined</i>			75	75	50	50	50	25	25	(4) bands on 6"; (3) bands on 3" to 5"; (2) bands on 1-1/2" to 2-1/2"
			75	75	50	50	50	25	25	(4) bands on 6"; (3) bands on 3" to 5"; (2) bands on 1-1/2" to 2-1/2"
			125	75	75	50	50	25	25	(4) bands on 6"; (3) bands on 3" to 5"; (2) bands on 1-1/2" to 2-1/2"
			125	75	75	50	50	25	25	(4) bands on 6"; (3) bands on 3" to 5"; (2) bands on 1-1/2" to 2-1/2"
			150	125	100	75	75			(5) bands on 3" & 4"; (4) bands on 2" & 2-1/2"; (3) bands on the res
			150	125	100	75	75			(5) bands on 3" & 4"; (4) bands on 2" & 2-1/2"; (3) bands on the res
			250	250	150	125	100	75	75	(3) bands on 6"; (2) bands on the rest
			250	250	150	125	100	75	75	(3) bands on 6"; (2) bands on the rest
			250	250		125	100			<i>Requires properly matched stem and ferrule.</i>
			600	600	600	600	500	450	400	
		800	800	600	600	500		400	Consult factory for ratings on IXF48-3 to IXF48-5 & IXF64-2 to IXF64-5 ferrules. <i>Internal Expansion is NOT recommended for XLPE, UHMWPE & Gum Rubber lined hoses.</i>	
Material Handling <i>no helical wire rubber lined</i>			75	75	50	50	50	25	25	(3) double bolt clamps on 5" & 6"; (2) double bolt clamps on 3" to 4"; (1) double bolt clamp on the rest
			125	75	75	50	50	25	25	(3) double bolt clamps on 5" & 6"; (2) double bolt clamps on 3" to 4"; (1) double bolt clamp on the rest
			150	125	100	75	75			(3) double bolt clamps on all sizes
Material Handling <i>cement rubber lined</i>	600	600	600	600	450	450	250		250	Cement will erode ID
	600	600	600	600	600	600	500	450	400	Cement will erode ID
	800	800	800	800	600	600	500		400	Cement will erode ID Consult factory for ratings on IXF48-3 to IXF48-5 & IXF64-2 to IXF64-5 ferrules.
Petroleum Transfer	125	125	125	75	75	50	50	25	25	(4) bands on 6"; (3) bands on 3" to 5"; (2) bands on 1-1/2" to 2-1/2"; (1) band on the rest
		125	125	75	75	50	50	25	25	(4) bands on 6"; (3) bands on 3" to 5"; (2) bands on 1-1/2" to 2-1/2"; (1) band on the rest
	150	150	150	125	100	75	75			(5) bands on 3" & 4"; (4) bands on 2" & 2-1/2"; (3) bands on 1-1/4" & 1-1/2"; (2) bands on the rest
		150	150	125	100	75	75			(5) bands on 3" & 4"; (4) bands on 2" & 2-1/2"; (3) bands on the rest
	250	250	250	250	150	125	100	75	75	(3) bands on 6"; (2) bands on the rest
		250	250	250	150	125	100	75	75	(3) bands on 6"; (2) bands on the rest
	250		250	250		125	100			<i>Requires properly matched stem and ferrule.</i>
	800	800	800	800	600	600	500		400	Consult factory for ratings on IXF48-3 to IXF48-5 & IXF64-2 to IXF64-5 ferrules.
600	600	600	600	600	600	500	450	400		
Air Craft Refueling <i>conforming to API 1529</i>	300	300	300	300	300	300	300			
Push-On										Push-On fittings should ONLY be used on Push-On hose.
Steam	250	250	250	250	250	250	250		250	
Water	150									(2) bands on 5/8" or larger; <i>Must use mating Dixon Air King fittings with safety clip installed. Band & Buckle is NOT recommended for 1-1/2" and smaller.</i>
	150									<i>Must use mating Dixon Air King fittings with safety clip installed. Band & Buckle is NOT recommended for 1-1/2" and smaller.</i>
	100									(1) band; <i>Band & Buckle is NOT recommended for 1-1/2" and smaller.</i>
	100									
	100	75	75	75	50	50	50	25	25	(4) bands on 6"; (3) bands on 3" to 5"; (2) bands on 1-1/2" to 2-1/2"; (1) band on the rest
		75	75	75	50	50	50	25	25	(4) bands on 6"; (3) bands on 3" to 5"; (2) bands on 1-1/2" to 2-1/2"; (1) band on the rest
	150	150	125	75	75	50	50	25	25	(4) bands on 6"; (3) bands on 3" to 5"; (2) bands on 1-1/2" to 2-1/2"; (1) band on the rest
	300	300	150	125	100	75	75			(5) bands on 3" & 4"; (4) bands on 2" & 2-1/2"; (3) bands on 1-1/4" & 1-1/2"; (2) bands on the rest
	250	250	250	250	150	125	100	75	75	(3) bands on 6"; (2) bands on the rest
		250	250	250	150	125	100	75	75	(3) bands on 6"; (2) bands on the rest
	250		250	250		125	100			<i>Requires properly matched stem and ferrule.</i>
	600	600	600	600	450	450	250		250	
	600	600	600	600	600	600	500	450	400	
Water <i>no helical wire</i>			75	75	50	50	50	25	25	(3) double bolt clamps on 5" & 6"; (2) double bolt clamps on 3" to 4"; (1) double bolt clamp on the rest
			125	75	75	50	50	25	25	(3) double bolt clamps on 5" & 6"; (2) double bolt clamps on 3" to 4"; (1) double bolt clamp on the rest
			150	125	100	75	75			(3) double bolt clamps on all sizes

Cam & Groove



poly replacement parts
page 36



slip-on flange x socket weld adapter
pages 53



buttweld to tube cam & groove
page 59

Boss Fittings



GJ Boss™ ground joint knurled nut
page 93

Air Fittings



global 4-lug Air King
page 103



in-line lubricator base
page 114



ASME air tank with a Watts filter and
Wilkerson combination unit with frame
page 117



Parker Ez-Mate industrial interchange couplers
page 123



high volume cannon and Typhoon blow guns
pages 138-139



polyurethane whip hose
page 141



Sharkbite® push-in fittings
pages 161-162



LIQUIfit™ Fittings
pages 185-189



process gauges
page 256

Shank Fittings



BSPT end King Combination nipples
page 264

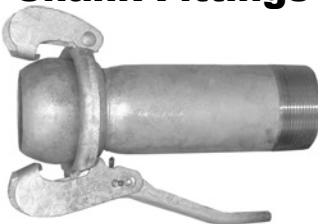

extra long quick connect fittings
page 273



heavy duty quick connect fittings
page 276

Brass Fittings



turbo garden hose nozzle
page 296



female 37° JIC / 45° SAE swivel x
push-on 90° elbows
page 307



female insert 90° elbows
page 310



female NPTF swivel x hose barb
page 312

Clamps



thumb screw clamps
page 334



constant torque clamps
page 344

Hydraulic Fittings

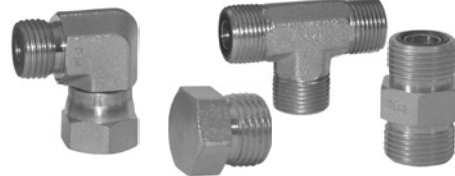

flat face fittings
pages 364-365

Sanitary Fittings



bolted clamp
page 409



tube buttweld x
schedule 5 buttweld adapter
page 410



buna-N DIN gasket
page 413

Fire Hose Fittings



500# SJ UL labeled fire hose
500# SJ color impregnated fire hose
page 448

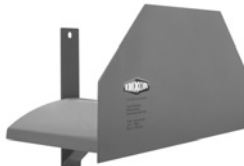

saddle hose racks
page 457



aluminum breakable cap
page 463



master stream nozzle
page 486



fire equipment cabinets
page 493

Valves



adjustable faucets
page 494



globe and check valves
page 496



one and two way ball valves
(socket weld end, grooved end)
pages 497-498

Tank Truck & Rack Equipment



fuel nozzles & accessories
pages 570-571



API coupler
page 582



TTMA flange extension
page 584



type 35 loading arm swivel
page 584

Dixon

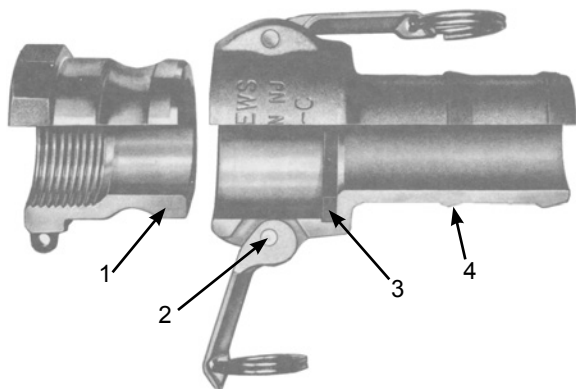

1. Precision machined to rigid tolerances.
2. Durable stainless steel cam arm pins will not rust or bind, for greater strength and safety.
3. Recess holds gasket firmly in place - ensures proper placement.
4. Long shank design allows proper banding, thus eliminating the major cause of hose damage.

Operation of Cam and Groove

1. To make connection, simply slide the adapter into the coupler and with normal hand pressure, press the cam levers down.
2. Uncoupling is as quick and simple as coupling. Just lift the cam arms and remove the adapter.

Boss-Lock



Boss-Lock cam and groove provides a *unique patented safety feature*. The cast-in lugs allow safety clips to be attached once the lugs are passed through slots in the special cam lever arms. These clips prevent the coupler from being unlocked until they are removed, providing a *positive locking action*.

Pull Ring Safety Clips



Dixon has developed the pull ring safety clip to simplify the locking action on Boss-Lock couplers. No more inserting clips or dangling lanyards, just a twist and it's locked, giving you a low profile *positive locking action*.

Buy with Confidence

Boss-Lock investment stainless steel cam arms are *guaranteed* ! Should you **ever** break a Boss-Lock investment stainless steel cam arm, simply return it to the nearest warehouse for a *free* replacement.

Ordering System



Size represents the coupler or adapter and hose or pipe end. (i.e. 200 = 2") If the coupling is a reducing size, the coupler or adapter is the first size. (i.e. 4030-C is 4" coupler to 3" hose shank).

Specifications on Dixon Cam and Groove

Specifications:

- Dixon, Boss-Lock and EZ Boss-Lock cam and groove couplers and adapters are produced to interchange with all product produced to Commercial Item Description A-A-59326B.
- No standard exists for the ½" and 8" fittings, and generally these sizes do not interchange with other manufacturers.
- Dust caps and dust plugs are **not** to be used in pressure applications for safety and environmental reasons.
- *Designed for use with liquids*, consult Dixon for specific recommendations.

Pressure Ratings:

SAFETY Recommendations based on the use of mating Dixon fittings at ambient temperature (70°F) with standard Buna-N Seal **ALERT** installed. For use at elevated temperature or other unusual operating conditions, consult the factory. Dixon, Boss-Lock and EZ Boss-Lock couplers and adapters maximum working pressure are as follows:

Size	½"	¾" thru 2"	2½"	3"	4"	5" and 6"	8"
PSI	150	250	150	125	100	75	50

EZ Boss-Lock

No more fumbling with clamps, wire, clips or pins.
Just close the handles and the locking
mechanism is engaged.

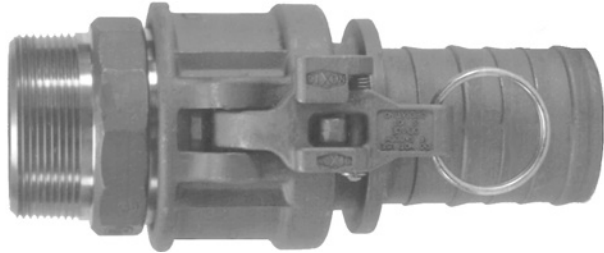

Unlike other safety couplings . . .

- *The EZ Boss-Lock is extremely easy to open!!!*
The release lever is under your thumb when you want to open the fitting. Ergonomic.
- *The EZ Boss-Lock is resistant to accidental disconnection when being dragged.* The release lever opens in the direction opposite to the cam arm, so movements that tend to open the release lever also tend to close the cam arm!!!
- *The EZ Boss-Lock alerts you if it is not properly engaged.* If the rotating lever is not flush with the handle, it is not properly engaged.
- *The EZ Boss-Lock has no sliding pins to jam.* The EZ Boss-Lock's rotating action helps keep the locking device free of debris.
- *The EZ Boss-Lock has no sliding pins to pop open.* The EZ Boss-Lock is designed to protect critical parts from impact and to withstand rugged use.
- *The EZ Boss-Lock can be supplied with special shanks custom suited to your needs.* The EZ Boss-Lock is available with swaged and PF shank designs for hard to couple chemical hoses.
- *The EZ Boss-Lock cam arm assemblies are made of investment cast stainless steel with plated carbon steel pull rings.*
- *The EZ Boss-Lock is easier to insert into the hose tubes on tank trucks, and easier to use in restricted spaces.* This is due to the smaller maximum OD and a more snag free exterior.
- *The EZ Boss-Lock cam arm assemblies can be retrofitted onto undamaged stainless steel Boss-Lock.* This allows you to protect your investment in stainless steel Boss-Lock couplings while you upgrade.

Cam and Groove Line Drawings

Line drawings are representative of the Dixon line of cam and groove.

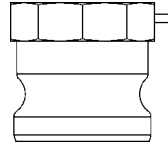

Type A
male adapter x female NPT

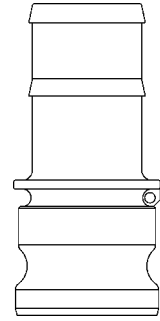

Type E
male adapter x hose shank

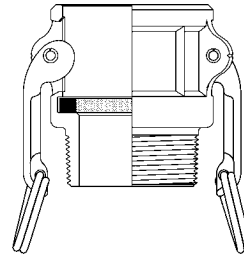

Type B
female coupler x male NPT

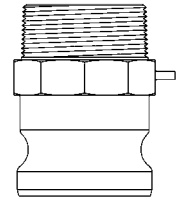

Type F
male adapter x male NPT

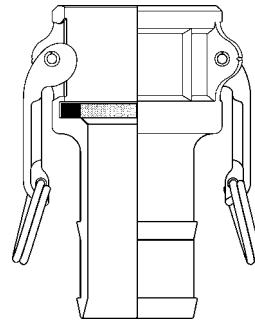

Type C
female coupler x hose shank

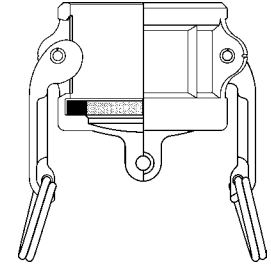

Type DC *
dust cap

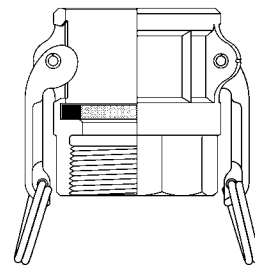

Type D
female coupler x female NPT

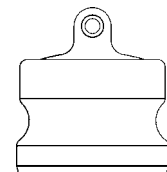

Type DP *
dust plug

* Dust caps and dust plugs are **not** to be used in pressure applications for safety and environmental reasons.

**SAFETY
ALERT**

Warning !

Under no circumstances should cam and groove couplings be used for compressed air or steam service!

**SAFETY
ALERT**